

Согласовано			

Применение: За отн. 0.000 принят верх перекрытия подвала (МОП 1 этажа)

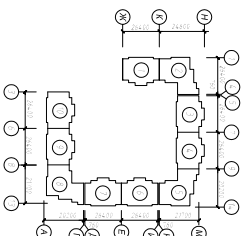
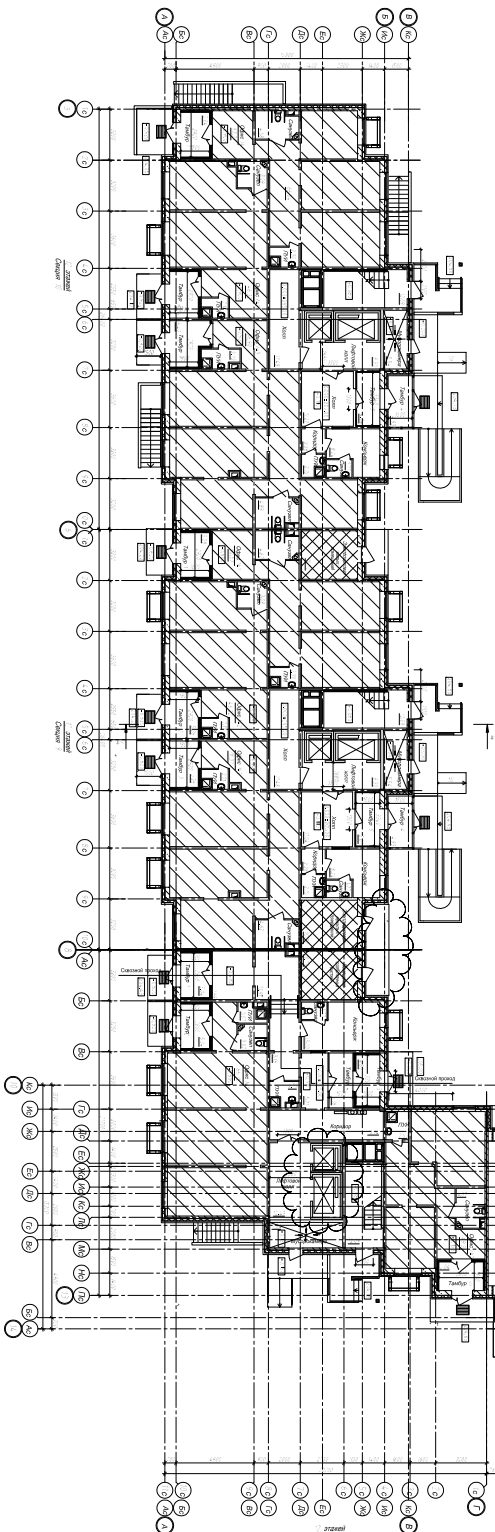
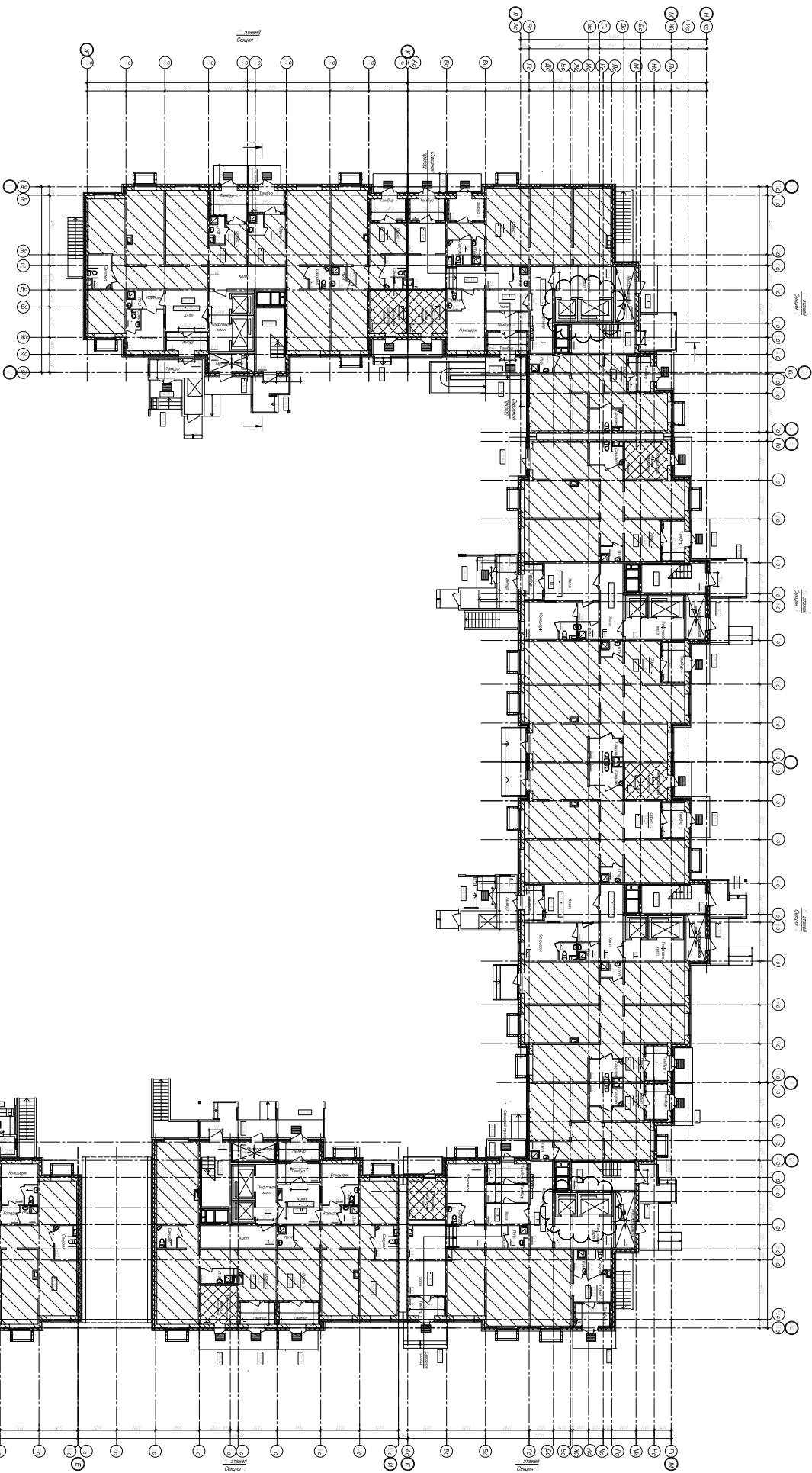

no. Account status		Final GP	
id	description		
7000	Costs		
7001	Insurance costs	1	
7002	Costs		
7003	Insurance costs	1	
7004	Costs		
7005	Insurance costs	1	
7006	Costs		
7007	Insurance costs	1	
7008	Costs		
7009	Insurance costs	1	
7010	Costs		
7011	Insurance costs	1	
7012	Costs		
7013	Insurance costs	1	
7014	Costs		
7015	Insurance costs	1	
7016	Costs		
7017	Insurance costs	1	
7018	Costs		
7019	Insurance costs	1	
7020	Costs		
7021	Insurance costs	1	
7022	Costs		
7023	Insurance costs	1	
7024	Costs		
7025	Insurance costs	1	
7026	Costs		
7027	Insurance costs	1	
7028	Costs		
7029	Insurance costs	1	
7030	Costs		
7031	Insurance costs	1	
7032	Costs		
7033	Insurance costs	1	
7034	Costs		
7035	Insurance costs	1	
7036	Costs		
7037	Insurance costs	1	
7038	Costs		
7039	Insurance costs	1	
7040	Costs		
7041	Insurance costs	1	
7042	Costs		
7043	Insurance costs	1	
7044	Costs		
7045	Insurance costs	1	
7046	Costs		
7047	Insurance costs	1	
7048	Costs		
7049	Insurance costs	1	
7050	Costs		
7051	Insurance costs	1	
7052	Costs		
7053	Insurance costs	1	
7054	Costs		
7055	Insurance costs	1	
7056	Costs		
7057	Insurance costs	1	
7058	Costs		
7059	Insurance costs	1	
7060	Costs		
7061	Insurance costs	1	
7062	Costs		
7063	Insurance costs	1	
7064	Costs		
7065	Insurance costs	1	
7066	Costs		
7067	Insurance costs	1	
7068	Costs		
7069	Insurance costs	1	
7070	Costs		
7071	Insurance costs	1	
7072	Costs		
7073	Insurance costs	1	
7074	Costs		
7075	Insurance costs	1	
7076	Costs		
7077	Insurance costs	1	
7078	Costs		
7079	Insurance costs	1	
7080	Costs		
7081	Insurance costs	1	
7082	Costs		
7083	Insurance costs	1	
7084	Costs		
7085	Insurance costs	1	
7086	Costs		
7087	Insurance costs	1	
7088	Costs		
7089	Insurance costs	1	
7090	Costs		
7091	Insurance costs	1	
7092	Costs		
7093	Insurance costs	1	
7094	Costs		
7095	Insurance costs	1	
7096	Costs		
7097	Insurance costs	1	
7098	Costs		
7099	Insurance costs	1	
7100	Costs		

[illegible]
$$\underline{S_{\text{станка}} = 2963,45 \text{ M2}}$$